

## 微型齒輪減速機系列 GEARMOTOR SERIES

### 調速型馬達 Speed variable motor



### 調速型馬達 Speed variable motor

特徵：適用於單相馬達作速度調整控制。

(50Hz：90~1400rpm、60Hz：90~1700rpm)

(註：三相馬達作速度控制時一般則用變頻器控制)

Feature: Applicable for speed adjustment for single-phase motor

(Note: The frequency converter is used for 3-phase motor, to control speed.)

### 馬達一般規格 Motor general specifications

絕緣阻抗：在馬達的線圈與外殼間以DC500V高阻計測定，其數值在100MΩ以上。

絕緣耐壓：在馬達的線圈與外殼間施加50Hz或60Hz、1.5KV，1分鐘無發生異常現象。

溫度上升：於馬達額定運轉後以電阻法測定，溫度上升值在80°C以下。

絕緣等級：B種(130°C)。

保護等級：導線型IP20

使用溫度：-10°C~+50°C (電容運轉馬達-10°C~+40°C) (不結凍狀態)

使用溼度：85%以下(不結露狀態)

調速型所搭配使用的控制器有組合式(SCU)及分離式(SCS)兩種控制器，於H35頁有詳細的規格介紹。

Insulation impedance: Measure with DC500V high resistance gauge between the coil and casing of motor, the reading is 100M or higher.

Insulation resistance to pressure: Apply 50Hz or 60Hz, 1.5KV between the coil and casing of motor for one minute without irregularity resulted.

Temperature rise: To specify by resistance method after motor reaches rated operation. Temperature is less than 80°C

Insulation B class (130°C)

Protection Motor with conductive wire is IP20

Operating temperature: -10°C~+50°C (Capacitor operation motor -10°C~+40°C) (No freezing)

Operating humidity: 85% or less (No condensation)

There are two types of controller; SCU (combined) and SCS (separated). See detailed specification on H35.

## 調速型馬達機型一覽表 List of speed adjustable type motor models

型號 Model		輸出功率 (W) Output power	電壓 (V) Voltage	極數 (P) Poles	頻率 (Hz) Frequency	起動轉矩 (KgcM) Starting Torque	電流 (A) Current	調速範圍 (r/min) Speed variable range	電容器容量 ( $\mu$ ) Capacitor's capacity	容許轉矩 Permissible torque	
圓軸 Round shaft	齒軸 Gear shaft									1200rpm	90rpm
CM06IA06SAV	CM06IG06SAV	6	1Ø110	4	50	0.42	0.26	90~1400	2.5(250V)	0.50	0.30
					60	0.38	0.27	90~1700			
CM06IA06SBV	CM06IG06SBV		1Ø220	4	50	0.46	0.15	90~1400	0.7(450V)	0.50	0.30
					60	0.52	0.14	90~1700			
CM07IA15SAV	CM07IG15SAV	15	1Ø110	4	50	0.91	0.41	90~1400	5(250V)	1.20	0.40
					60	0.90	0.47	90~1700			
CM07IA15SBV	CM07IG15SBV		1Ø220	4	50	0.92	0.18	90~1400	1.2(450V)	1.20	0.40
					60	0.94	0.20	90~1700			
CM08IA25SAV	CM08IG25SAV	25	1Ø110	4	50	1.14	0.54	90~1400	6(250V)	1.90	0.45
					60	1.22	0.64	90~1700			
CM08IA25SBV	CM08IG25SBV		1Ø220	4	50	1.32	0.31	90~1400	1.5(450V)	2.00	0.45
					60	1.42	0.32	90~1700			
CM09IA40SAV	CM09IG40SAV	40	1Ø110	4	50	2.25	0.72	90~1400	10(250V)	2.50	0.70
					60	2.30	1.00	90~1700			
CM09IA40SBV	CM09IG40SBV		1Ø220	4	50	2.03	0.40	90~1400	2.5(450V)	2.50	0.70
					60	2.11	0.48	90~1700			
CM09IA60SA□V	CM09IG60SA□V	60	1Ø110	4	50	3.43	1.70	90~1400	16(250V)	2.00	2.00
					60	3.57	1.73	90~1700			
CM09IA60SB□V	CM09IG60SB□V		1Ø220	4	50	3.69	0.80	90~1400	4(450V)	2.00	2.00
					60	3.65	0.85	90~1700			
CM09IA90SA□V	CM09IG90SA□V	90	1Ø110	4	50	5.75	2.00	90~1400	20(250V)	7.50	2.00
					60	5.83	2.50	90~1700			
CM09IA90SB□V	CM09IG90SB□V		1Ø220	4	50	5.90	0.90	90~1400	6(450V)	7.50	2.60
					60	6.04	1.06	90~1700			

● 如馬達特性變更，恕不另行通知，以馬達銘牌為準

In case of change of motor characteristics, no further notice shall be given. The information shown on the nameplate of motor is taken as standard.



# 微型齒輪減速機系列 GEARMOTOR SERIES

6w

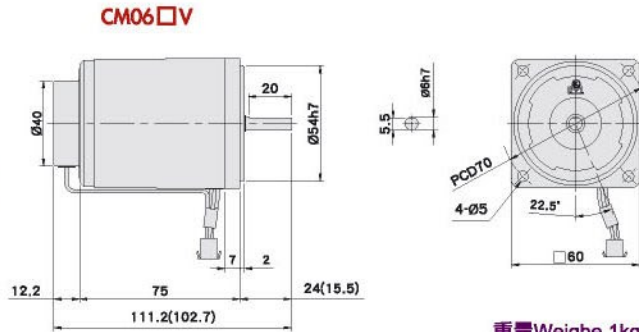

重量Weighe 1kg  
( )內為齒軸尺寸  
( ) is for helical gear shaft

**CM06□V/CG06□S8**

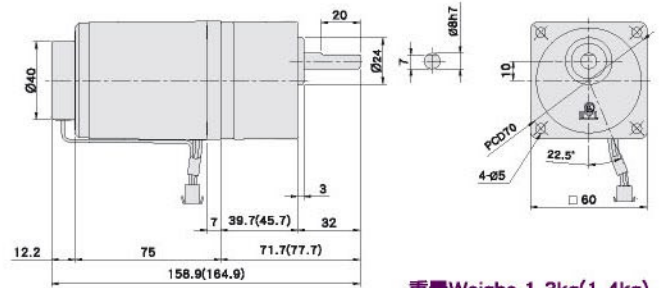

重量Weighe 1.3kg(1.4kg)  
( )內為1/90~1/300之尺寸.重量  
( ) is for ratio 1/90~1/300 measurement/weight

15w

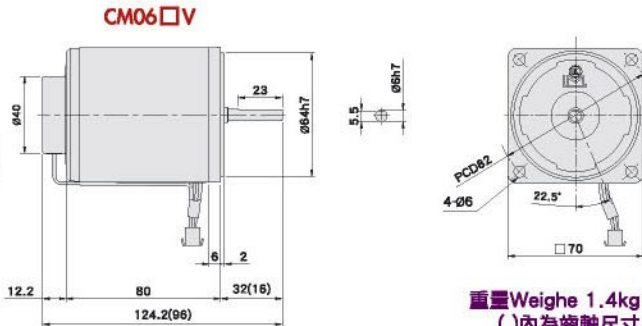

重量Weighe 1.4kg  
( )內為齒軸尺寸  
( ) is for helical gear shaft

**CM07□V/CG07□S10**

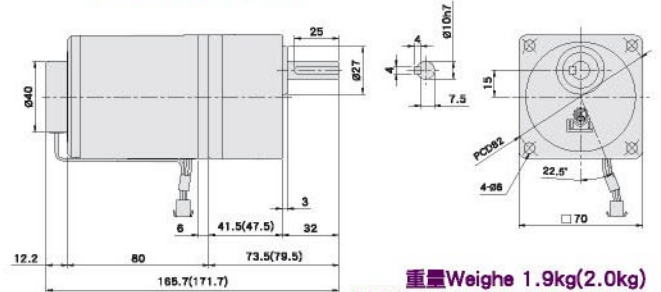

重量Weighe 1.9kg(2.0kg)  
( )內為1/90~1/240之尺寸.重量  
( ) is for ratio 1/90~1/240 measurement/weight

25w

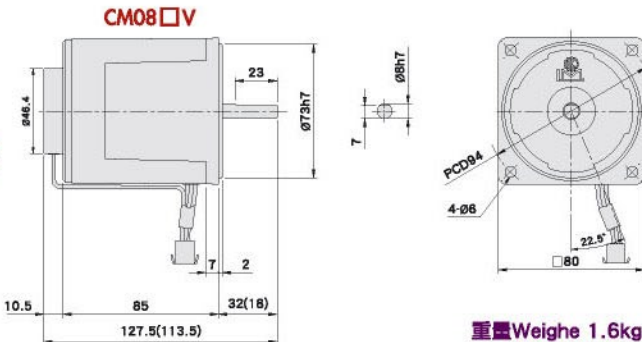

重量Weighe 1.6kg  
( )內為齒軸尺寸  
( ) is for helical gear shaft

**CM08□V/CG08□S10**

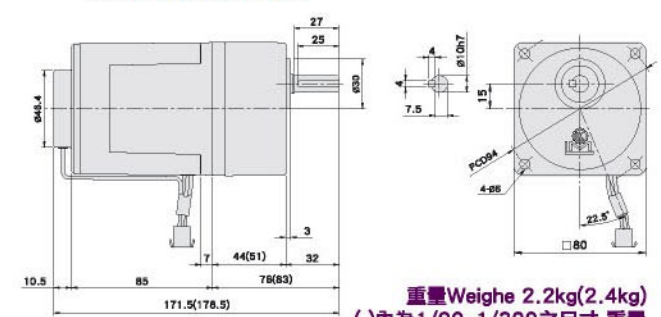

重量Weighe 2.2kg(2.4kg)  
( )內為1/90~1/300之尺寸.重量  
( ) is for ratio 1/90~1/300 measurement/weight

40w

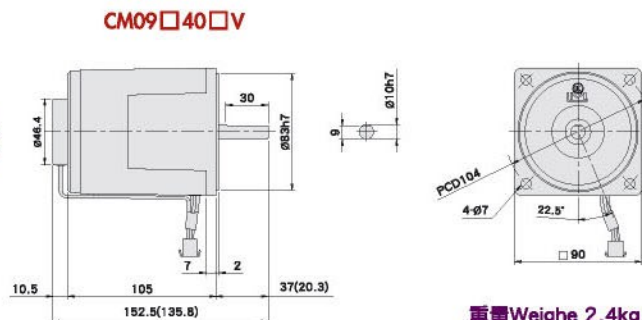

重量Weighe 2.4kg  
( )內為齒軸尺寸  
( ) is for helical gear shaft

**CM09□40□V/CG09□S12**

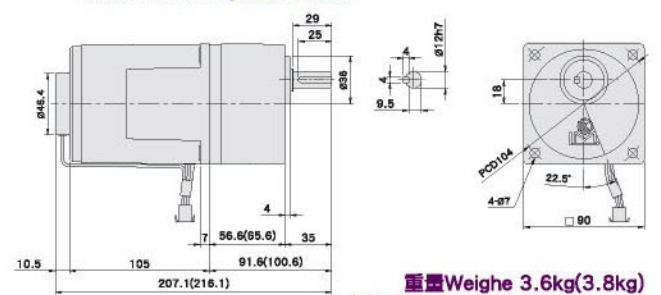

重量Weighe 3.6kg(3.8kg)  
( )內為1/90~1/240之尺寸.重量  
( ) is for ratio 1/90~1/240 measurement/weight

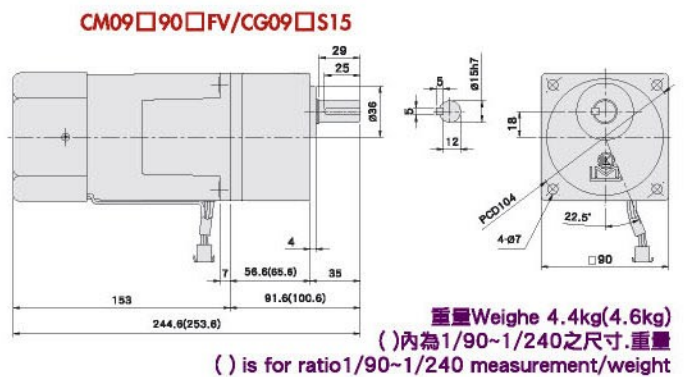
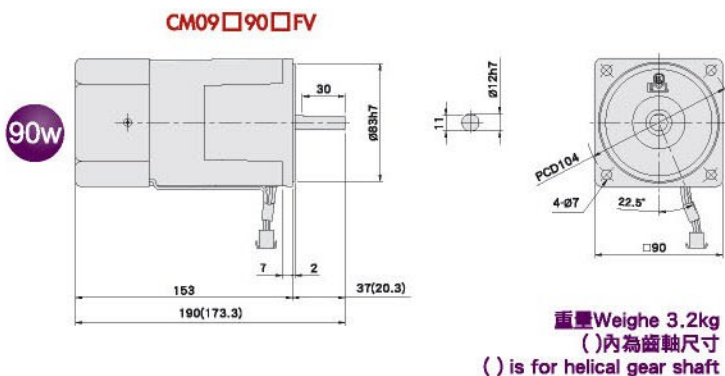
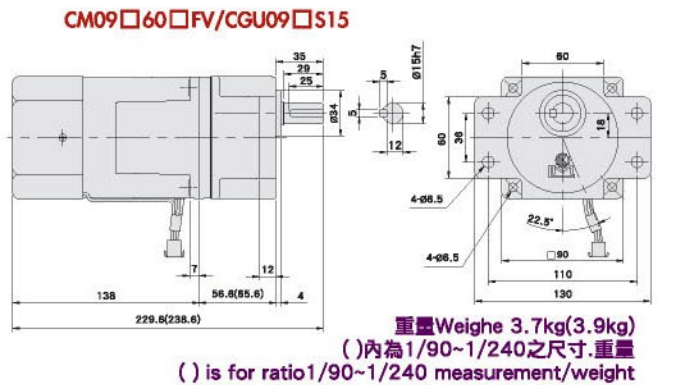
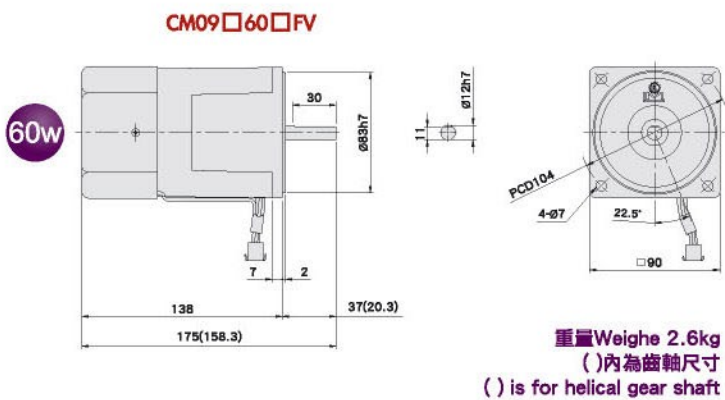
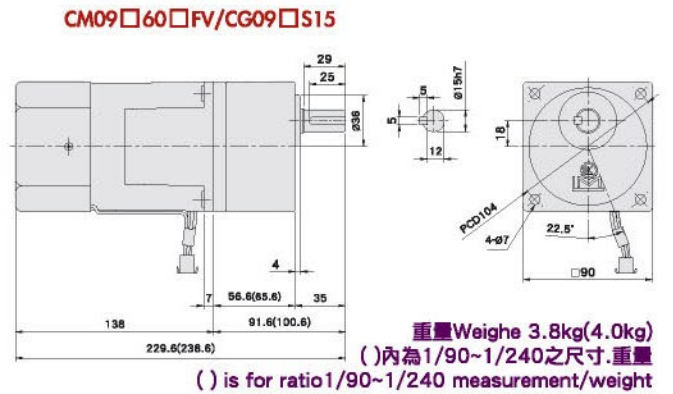
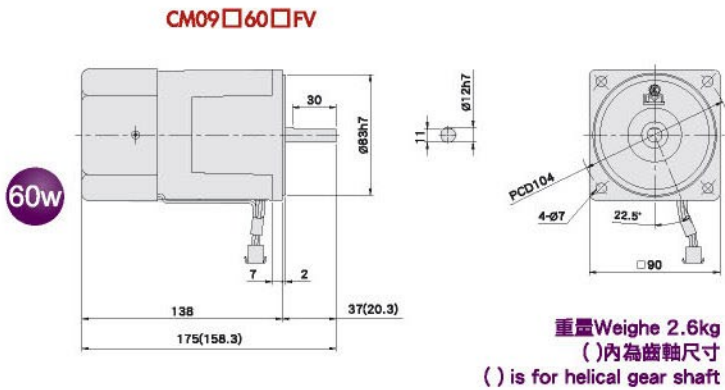
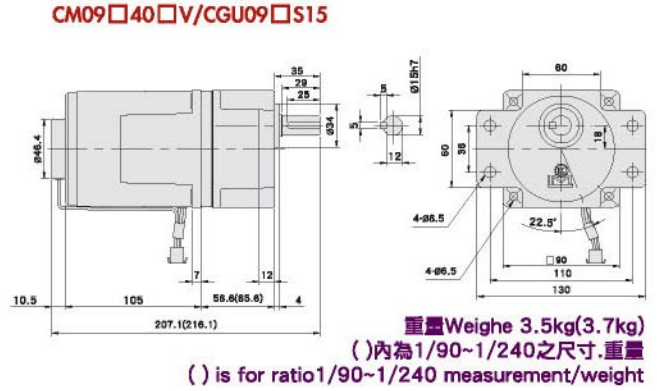
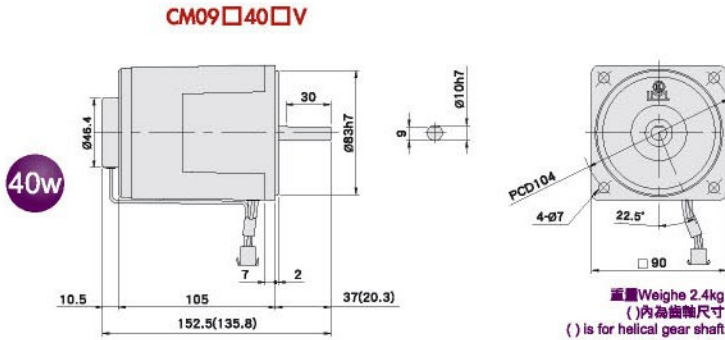



# 微型齒輪減速機系列 GEARMOTOR SERIES

CM09□90□FV

90w

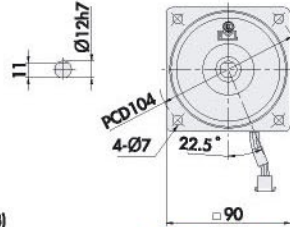
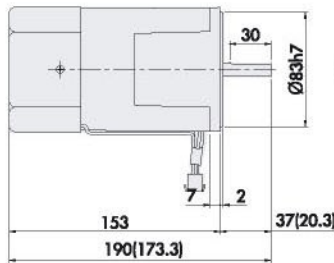

重量Weight 3.2kg  
( )內為齒軸尺寸  
( ) is for helical gear shaft

CM09□90□FV/CGU09□S15

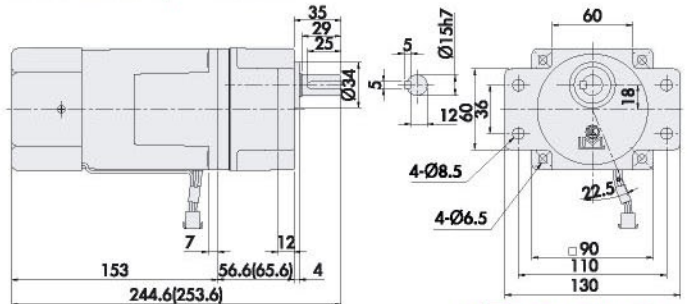

重量Weight 4.3kg(4.5kg)  
( )內為1/90~1/240之尺寸.重量  
( ) is for ratio 1/90~1/240 measurement/weight

CM09□60□CFV

60w

強制風扇  
with compulsory fan

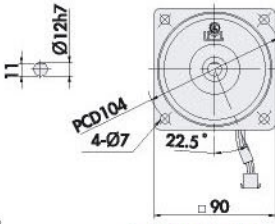
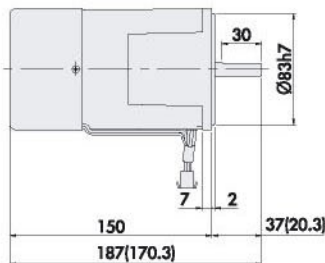

重量Weight 2.8kg  
( )內為齒軸尺寸  
( ) is for helical gear shaft

CM09□60□CFV/CG09□S15

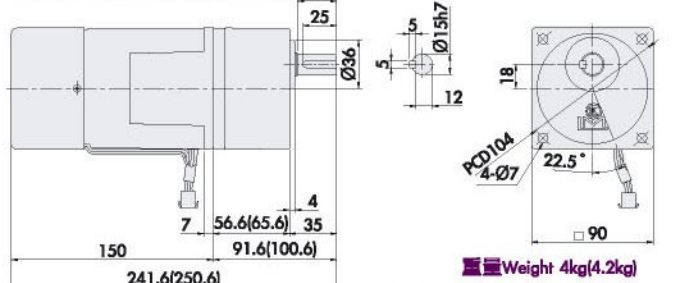

重量Weight 4kg(4.2kg)  
( )內為1/90~1/240之尺寸.重量  
( ) is for ratio 1/90~1/240 measurement/weight

CM09□60□CFV

60w

強制風扇  
with compulsory fan

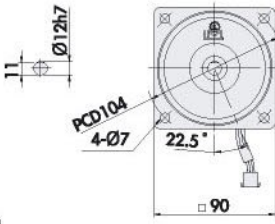
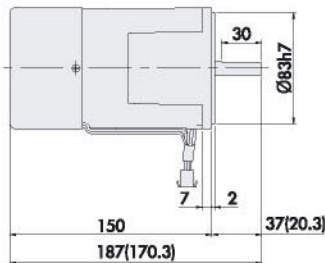

重量Weight 2.8kg  
( )內為齒軸尺寸  
( ) is for helical gear shaft

CM09□60□CFV/CGU09□S15

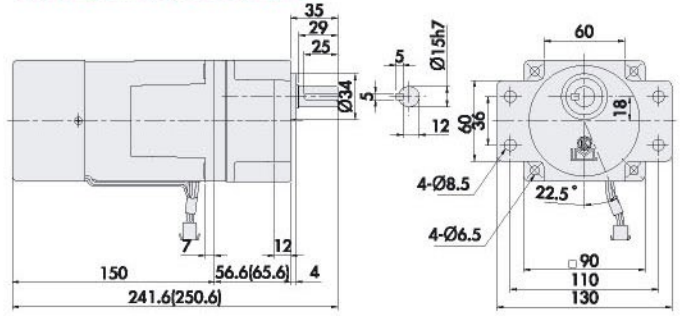

重量Weight 3.9kg(4.1kg)  
( )內為1/90~1/240之尺寸.重量  
( ) is for ratio 1/90~1/240 measurement/weight

CM09□90□CFV

90w

強制風扇  
with compulsory fan

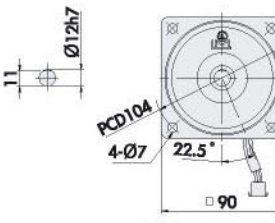
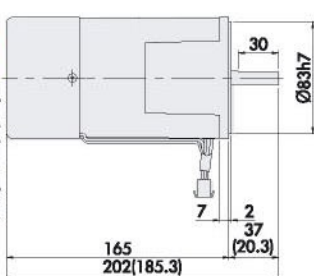

重量Weight 3.5kg  
( )內為齒軸尺寸  
( ) is for helical gear shaft

CM09□90□CFV/CG09□S15

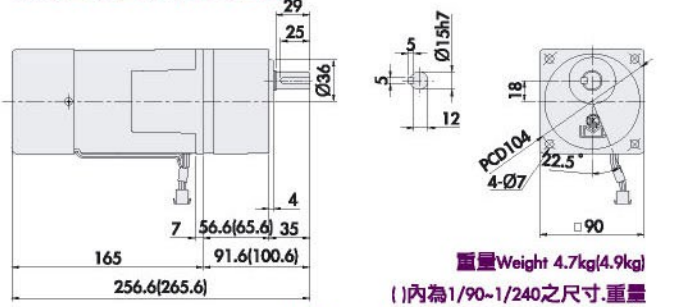

重量Weight 4.7kg(4.9kg)  
( )內為1/90~1/240之尺寸.重量  
( ) is for ratio 1/90~1/240 measurement/weight

90w  
空壓無回轉  
with compulsory fan

CM09□90□CFV

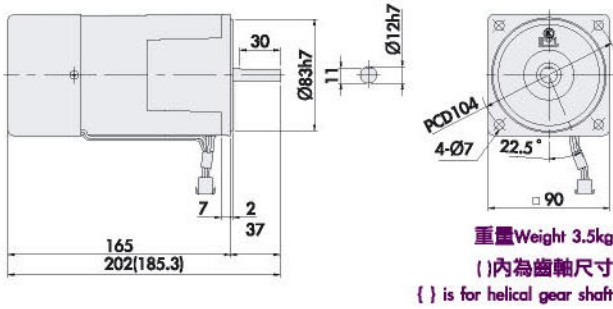

CM09□90□CFV/CGU09□S15

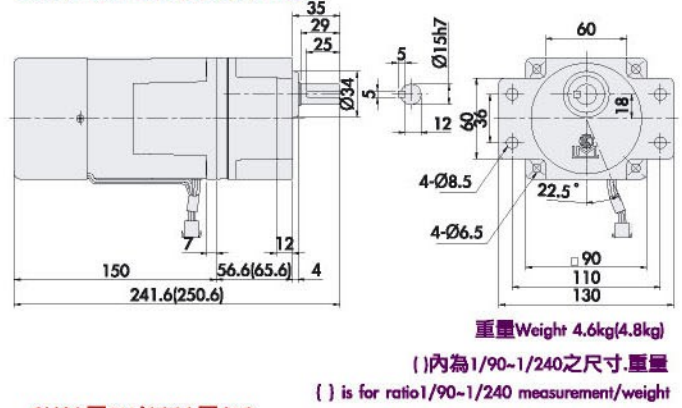

25w  
空壓磁煞車  
with electro magnetic brake

CM08□BV

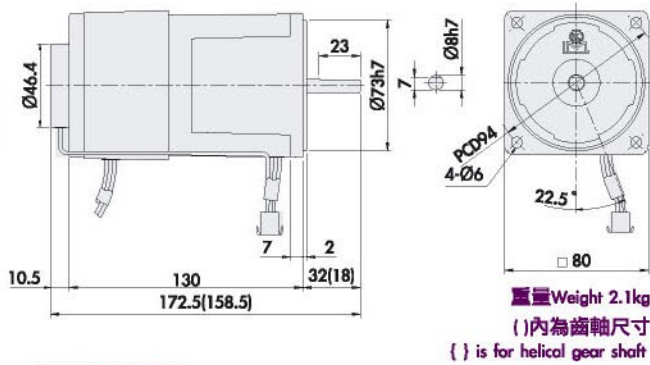

CM08□BV/CG08□S10

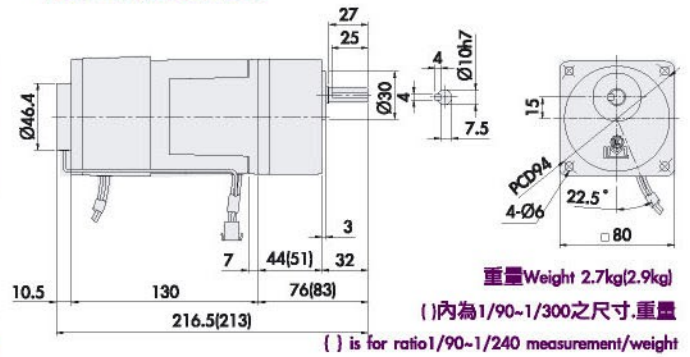

40w  
空壓磁煞車  
with electro magnetic brake

CM09□40□BV

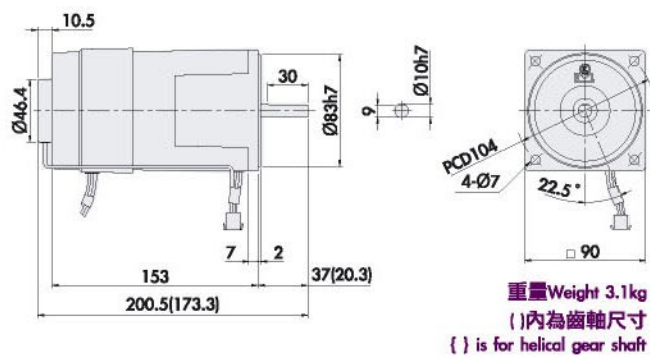

CM09□40□BV/CG09□S12

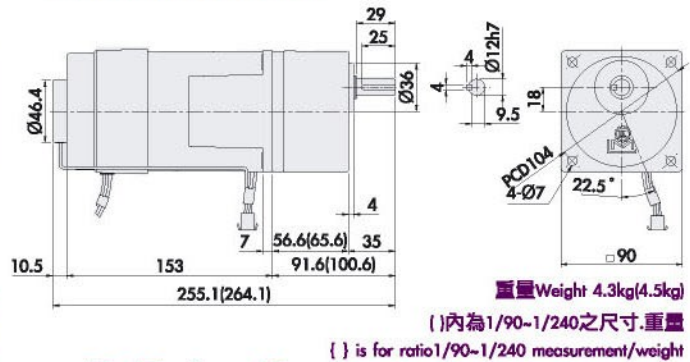

40w  
空壓磁煞車  
with electro magnetic brake

CM09□40□BV

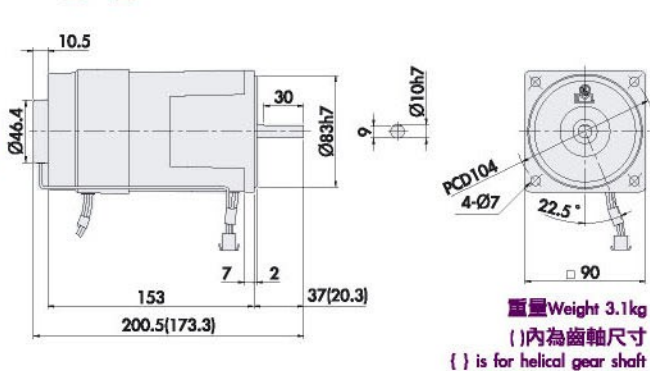

CM09□40□BV/CGU09□S15

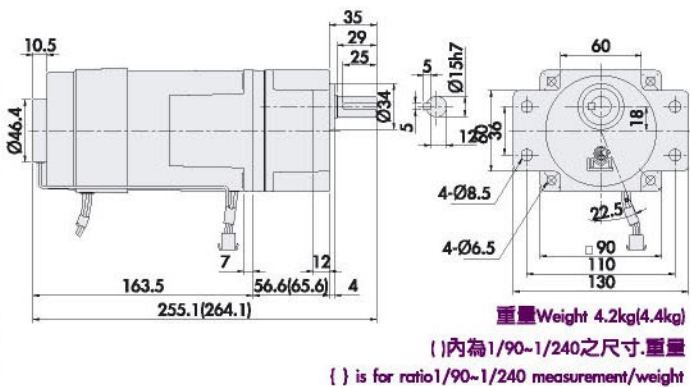



# 微型齒輪減速機系列 GEARMOTOR SERIES

60w

空轉接系統  
with electromagnetic brake

CM09□60□FBV

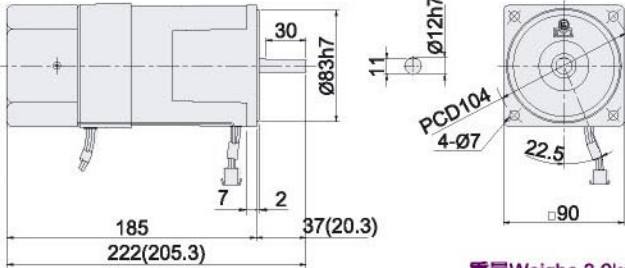

重量 Weighe 3.2kg  
( )內為齒軸尺寸  
( ) is for helical gear shaft

CM09□60□FBV/CGU09□S15

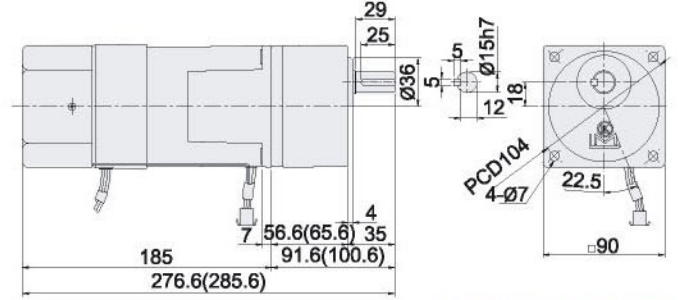

重量 Weighe 4.4kg(4.6kg)  
( )內為1/90~1/300之尺寸.重量  
( ) is for ratio 1/90~1/300 measurement/weight

60w

空轉接系統  
with electromagnetic brake

CM09□60□FBV

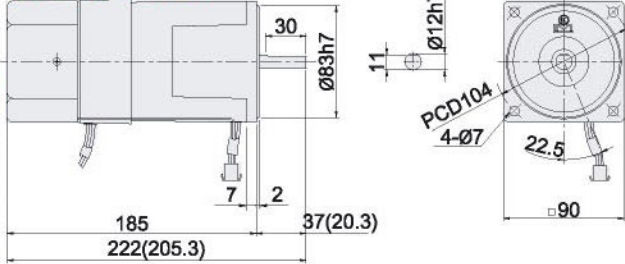

重量 Weight 3.2kg  
( )內為齒軸尺寸  
( ) is for helical gear shaft

CM09□60□FBV/CGU09□S15

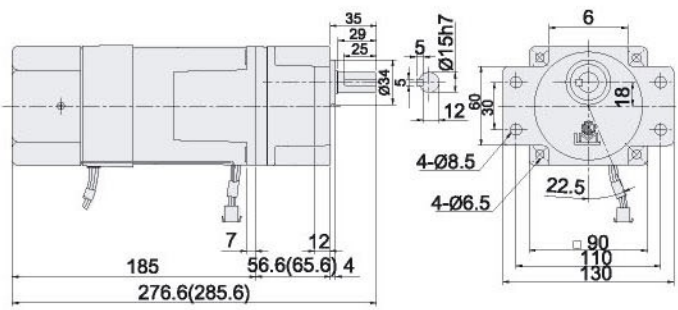

重量 Weight 4.3kg(4.5kg)  
( )內為1/90~1/300之尺寸.重量  
( ) is for ratio 1/90~1/300 measurement/weight

90w

空轉接系統  
with electromagnetic brake

CM09□90□FBV

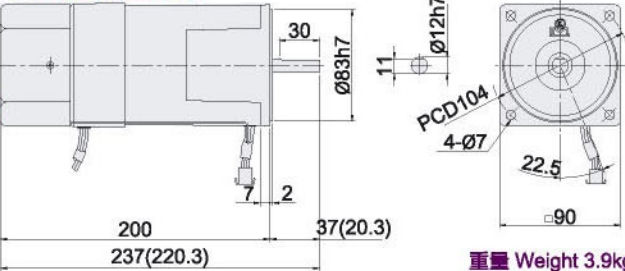

重量 Weight 3.9kg  
( )內為齒軸尺寸  
( ) is for helical gear shaft

CM09□90□FBV/CGU09□S15

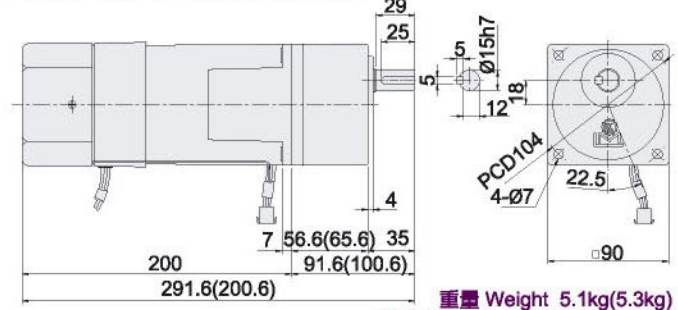

重量 Weight 5.1kg(5.3kg)  
( )內為1/90~1/240之尺寸.重量  
( ) is for ratio 1/90~1/300 measurement/weight

90w

空轉接系統  
with electromagnetic brake

CM09□90□FBV

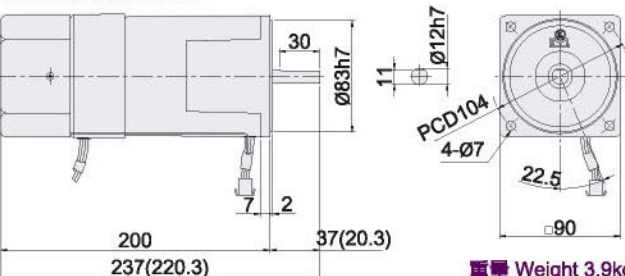

重量 Weight 3.9kg  
( )內為齒軸尺寸  
( ) is for helical gear shaft

CM09□90□FBV/CGU09□S15

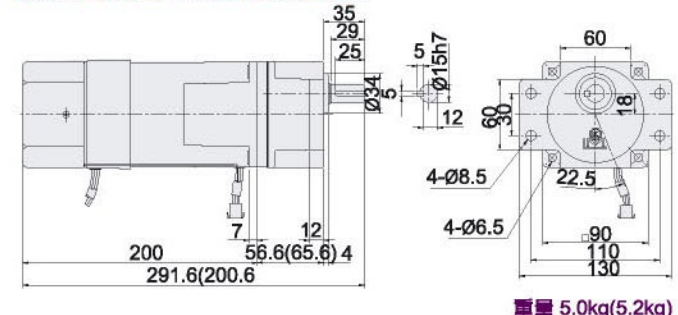

重量 5.0kg(5.2kg)  
( )內為1/90~1/240之尺寸.重量  
( ) is for ratio 1/90~1/300 measurement/weight